

# ST PHILOMENA SCHOOL

## Ministerial infrastructure designation



### ❖ What is the purpose

The ministerial infrastructure designation is proposed to facilitate the efficient allocation of resources and enable the timely supply of community infrastructure.

The proposed extensions to the existing education establishment include the redevelopment of the school. The ministerial designation is proposed to enable the construction of the development without being constrained by process.

The redevelopment of the school as part of a master plan includes the development of a multipurpose sports hall, place of worship, amenity buildings, classrooms and a senior oval.

### Proposed development

The Master Plan has recently obtained approval from the Logan City Council (COM/78/2017) and intends to commence part of the construction in late 2019. As part of a Master Plan, the proposed development for the educational facility includes the removal of five dilapidated buildings to accommodate the junior oval and additional parking.

The extension to the school includes the construction of a new place of worship which will be used by the school and the St Philomena parish.

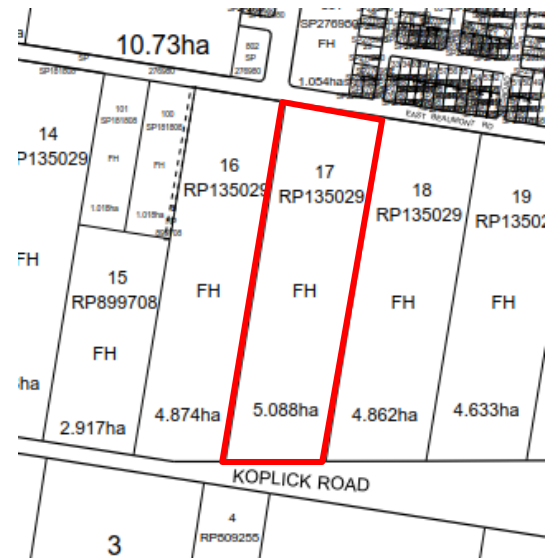

### ❖ Intent of the masterplan

The masterplan has four key intentions, including:

- Facilitate future development on site in an orderly sequence;
- Reduce the cost and timing of future applications;
- Addresses constraints at a site-specific level.

Efficient Buildings

Better Facilities

Quality Education

Community Benefits

# Masterplan

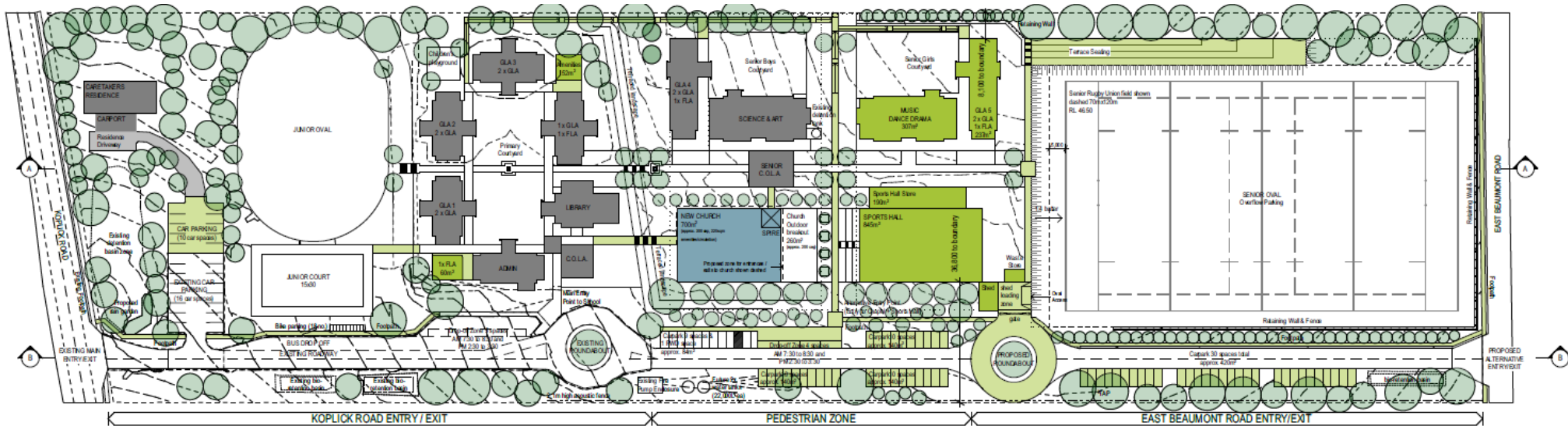

Approved/Existing Buildings and Structures

Approved/Existing Roads and Hard Landscaping

Proposed Church

Proposed Buildings and Structures

Proposed Roads and Hard Landscaping

Landscaping

## Carparking

Carparking – 75 spaces (total approx. 1050m<sup>2</sup>)

PWD Carpark – 1 space (total approx. 28m<sup>2</sup>)

Drop off/ pick up bays – 9 spaces (total approx. 140m<sup>2</sup>)

Total carparking – 85 spaces (total approx. 1218m<sup>2</sup>)